

* DIAPHRAGMS REQUIRED AT 1/3 POINTS FOR SPANS
UP TO 12 m AND AT 1/4 POINTS FOR SPANS
OVER 12 m.

* \varnothing CONCRETE DIAPHRAGMS
W/ 25 \varnothing THREADED RODS

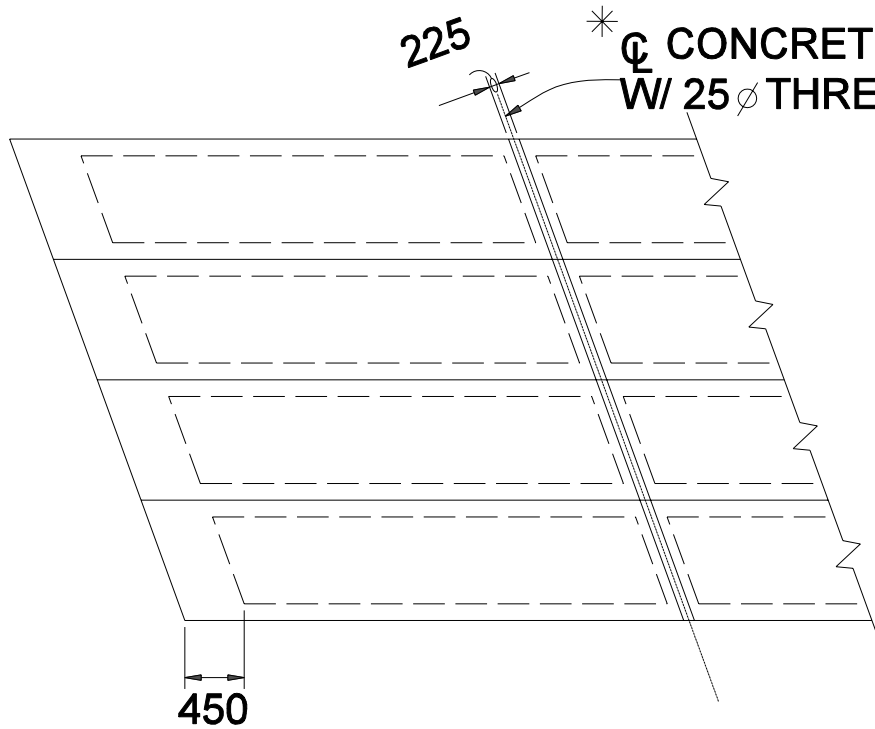

PARTIAL PLAN
(SKEW UP TO 20°)

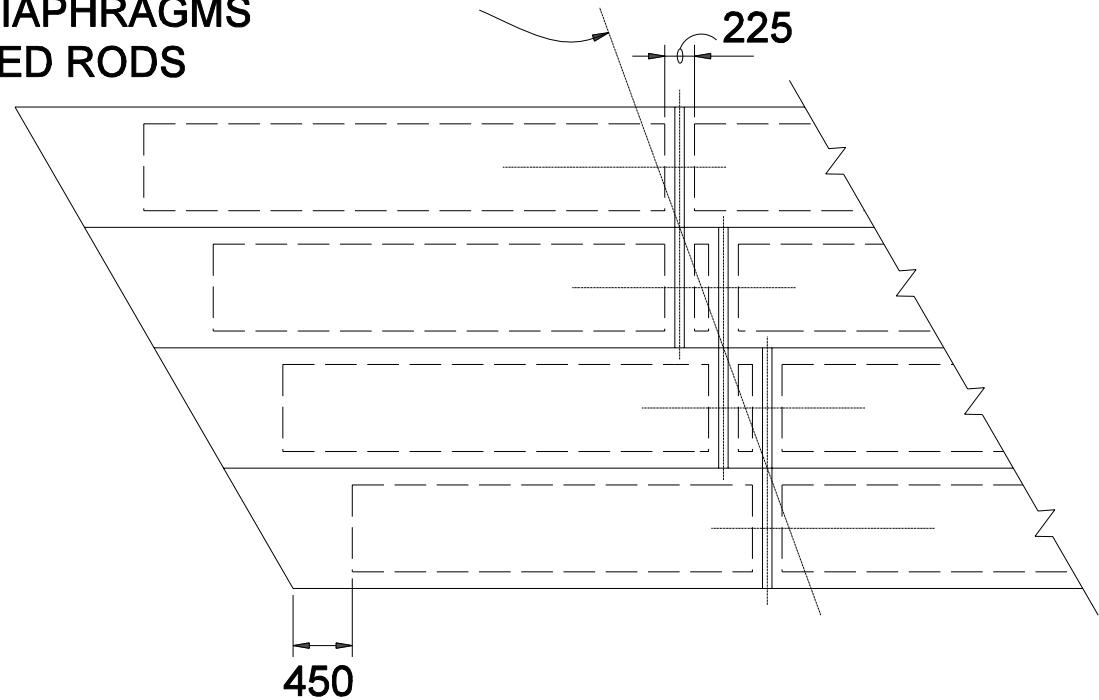

PARTIAL PLAN
(SKEW OVER 20°)

ADJACENT BOX BEAMS
(With Transverse Tensioning Rods)

Figure 63-8B